

# Honeywell

## HEPA AIR PURIFIERS

Owner's Manual



HPA160

HPA060

---

**HPA060 SERIES**  
**HPA160 SERIES**

---

If you have any questions about the operation of this product, please call us toll-free at **1-800-477-0457**, or visit our website at: [www.HoneywellPluggedIn.com/contact-us](http://www.HoneywellPluggedIn.com/contact-us).

# **IMPORTANT SAFETY INSTRUCTIONS**

## **READ AND SAVE THESE SAFETY INSTRUCTIONS BEFORE USING THIS AIR PURIFIER**

When using electrical appliances, basic precautions should always be followed to reduce the risk of fire, electric shock, and injury to persons, including the following:

1. Read all instructions before operating the air purifier.
2. Place air purifier where it is not easily overturned by persons in the household.
3. **ALWAYS** turn the air purifier controls to the **OFF** position and unplug from the wall outlet when not in use.
4. To disconnect the air purifier, make sure the unit is powered **OFF** then grip the plug and pull it from the wall outlet. **NEVER** pull by the cord.
5. **DO NOT** use any product with a damaged cord or plug, any product that malfunctions, or any product that has been dropped or damaged in any manner.
6. **DO NOT** use air purifier outdoors.
7. **DO NOT** use air purifier unless it is fully assembled.
8. **DO NOT** run power cord under carpets, and **DO NOT** cover with throw rugs. Arrange cord such that it will not be a tripping hazard.
9. **DO NOT** use air purifier where combustible gases or vapors are present.
10. **DO NOT** expose the air purifier to rain, or use near water, in a bathroom, laundry area, or other damp location.
11. The air purifier **MUST** be used in its upright position.
12. **DO NOT** allow foreign objects to enter ventilation or exhaust opening as this may cause electric shock or damage to the air purifier. **DO NOT** block air outlets or intakes.
13. Locate air purifier near the outlet and **DO NOT** use with extension cord or power strip.
14. This appliance has a polarized plug (one blade is wider than the other). To reduce the risk of electric shock, this plug is intended to fit only one way in a polarized outlet. If the plug does not fit fully in the outlet, reverse the plug. If it still does not fit, contact a qualified electrician. **DO NOT** attempt to defeat this safety feature.
15. A loose fit between the AC outlet (receptacle) and plug may cause overheating and a distortion of the plug. Contact a qualified electrician to replace loose or worn outlet.
16. **DO NOT** sit, stand, or place heavy objects on the air purifier.
17. **ALWAYS** disconnect power supply before servicing.
18. Keep out of reach of children and pets.
19. Filters may be harmful if ingested. Avoid breathing dust when changing filters.
20. **SAVE THESE INSTRUCTIONS.**

For FCC compliance information, please see last page of this manual.

 **WARNING: To Reduce The Risk of Fire or Electric Shock, DO NOT Use This Air Purifier With Any Solid-State Speed Control Device.**

# GETTING TO KNOW YOUR AIR PURIFIER

## HPA060 Series

Control Panel



Type **H** Certified  
HEPA Filter (1)



Type **B+** Genuine  
Household Gas & Odor  
Reducing Pre-Filter



Rear  
Grille



## HPA160 Series

Control Panel



Type **H** Certified  
HEPA Filters (2)



Type **B+** Genuine  
Household Gas & Odor  
Reducing Pre-Filter



Rear  
Grille



# HOW YOUR AIR PURIFIER WORKS

This model air purifier incorporates a 2-stage cleaning system to help clean the air that passes through the filter in the unit (Fig. 1).

- Stage 1:** Type **B+** Household Gas & Odor Reducing Pre-Filter
- Stage 2:** Type **H** Certified HEPA Filter captures the following microscopic airborne allergens and particles: dust, pollen, pet dander, dust mite debris and smoke as small as 0.3 microns from the air that passes through the filter

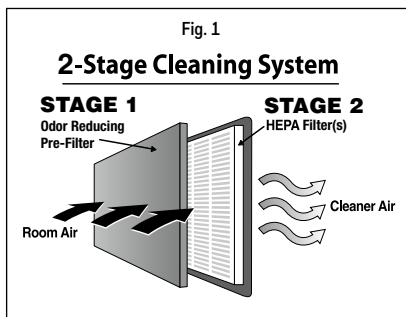

## GETTING STARTED

- Select a firm, level, and flat location.
- When operating, large volumes of air are drawn toward the air purifier. Surrounding areas should be cleaned and/or vacuumed frequently to prevent build-up of dust and other contaminants. This may also help prolong the life of the filter. If the unit is placed on a light colored carpet, a small mat or rug should be used underneath to prevent staining. This is especially important in homes with contamination from smoking, fireplaces, or where candles are burned.
- Ensure the front of the unit faces away from the closest wall or furniture.
- Ensure no grilles are blocked.

## INSTALL CERTIFIED HEPA FILTERS AND ODOR REDUCING PRE-FILTER

The Certified HEPA Filters are supplied within the air purifier. They are wrapped to ensure purity, and are labeled to help identify the proper replacement filter .

- Before using your new air purifier you must remove the wrapper covering the filter(s). Make sure the air purifier is OFF and unplugged. While pressing on the tab at the top of the rear grille, pull the grille towards you and remove it from the unit and set it aside (See Fig. 2). Grasp the sides of each filter frame near its top end and pull outward.
- Repeat for the second filter if applicable.
- Remove protective wrap from the filter(s).
- Place the HEPA Filter(s) into the air purifier housing with the arrows pointing toward the unit. Insert the bottom edge of the filter frame and press the top of the filter down and inward until the filter is firmly in place. Repeat for the second filter if applicable.



Fig. 2

Install the Household Gas & Odor Reducing Pre-Filter that is supplied within the air purifier. It will be wrapped in plastic wrap to keep it fresh .

- Remove the pre-filter from the protective plastic bag.
- Secure the pre-filter under the pre-filter clips on the inside of the rear grille.
- Replace the rear grille by lining up the tab at the bottom of the grille with the slot in the air purifier. Push the top of the grille towards the unit until it snaps in place. Snap the filter grille back into place.

## OPERATION



This product earned the ENERGY STAR label by meeting strict energy efficiency guidelines set by the U.S. EPA. Room air cleaners have demonstrated the potential for improving air quality and providing health benefits. EPA does not endorse manufacturer claims regarding the degree to which a specific product will produce healthier indoor air.

The energy efficiency of this ENERGY STAR certified model is measured based on a ratio between the model's CADR for Smoke and the electrical energy it consumes, or CADR/Watt.

## OPERATION (Cont.)

Portable air purifiers are more effective in rooms where all doors and windows are closed. It is recommended that you run your air purifier while you are at home to help clean the air.

### HPA060 Series Operation:

- Once you have removed the protective wrappers from the filters and have installed them in the unit, ensure the air purifier's control knob is turned to the OFF position and plug the power cord into a working outlet.
- Select desired cleaning level by turning knob to Low, Medium, or High setting (Fig. 3).



Fig. 3 HPA060 Control Panel

### Model HPA160 Series Operation:

- Once you have removed the protective wrappers from the filters and have installed them in the unit, plug the power cord into a working electrical outlet.
- Select cleaning level by simply TAPPING the power icon (🌿) to toggle through setting options. The blue LED will illuminate the selected setting. TAPPING the Power button will also shut the unit OFF after moving through the cleaning settings.

**HPA160 Series models have a Turbo Setting option.** (Not available on the HPA060 Series):

To select the Turbo setting, push the Turbo button (🌀). The Turbo LED will illuminate (Fig. 4). Push the Turbo button again and the air purifier will return to the previously selected cleaning level.

### Using the Timer Option (Not available on the HPA060 Series):

The HPA160 series models also have an **Automatic Shut-off Timer option**. If you would like the unit to automatically shut off after a specific period of time, push the Timer button (🕒) and toggle through to select 2, 4, or 8 hours. The air purifier will automatically shut off after the selected time period.



Fig. 4 HPA160 Control Panel

- To set the unit for Automatic Shut Off, push the Auto-off Timer icon (🕒).
- Continue to push the timer button to toggle through to the desired time setting.
- An LED will illuminate under the hour setting to indicate the selected run time.
- The unit will automatically shut off after the indicated run time.

## ELECTRONIC FILTER CLEAN REMINDER

These air purifier models each have two electronic filter checks to remind you when to check and replace the HEPA Filter(s) and Household Gas & Odor Reducing Pre-Filter based on the air purifier's hours of use.

When the HEPA Filter(s) need to be replaced, a red LED on the Check Filter(s) button will come on and remain on until it is RESET. You may unplug the air purifier without interrupting the filter check.

A red LED on the "Check Pre-Filter" button will illuminate when it is time to replace the pre-filter.

You should periodically check these filters. Depending on operating conditions, the HEPA Filters should be replaced every 12 months, and the Household Gas & Odor Reducing Pre-Filter every 3 months, especially if there have been heavy odors in the home.

### To RESET Either Electronic Filter Check:

When a filter check light remains on, it is time to replace the HEPA or Pre-Filter and reset the filter check light. With the unit powered on, press the lighted button and hold for approximately 2 seconds until the light turns off. Depending on individual usage (environment and hours used), you may need to check and replace filters more or less frequently.

These cleaning intervals are intended as guidelines only. Performance of any filter media is dependent upon the concentration of particles going through the system. High concentrations of particles such as dust, pet dander and smoking will reduce the useful performance of the filter.

**NOTE:** None of the filters are washable. **DO NOT** immerse them in water.

**WARNING:** Filters may be harmful if ingested. Avoid breathing dust when changing filters.

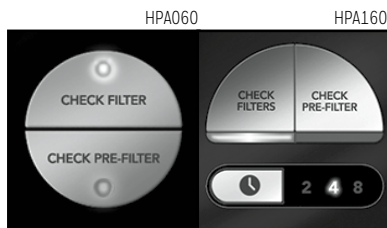





Fig. 5 Will illuminate when it is time to change HEPA filters

## FILTER REPLACEMENT

See INSTALLATION INSTRUCTIONS on page 3 of this manual.

The Certified HEPA Filter  should be replaced one time per year for optimum performance. The Replacement  Filters are available as model HRF-H1 (single pack) or HRF-H2 (2 pack).

If you would like your air purifier to remain effective at reducing household odors, and to operate most effectively, you should replace the Household Gas & Odor Reducing Pre-Filter once every 3 months. This Pre-Filter is available as the Household Gas & Odor Reducing Pre-Filter  or model HRF-B1 (single pack) or HRF-B2 (2 pack).

To help ensure stated product performance, use only Genuine Honeywell Replacement Filters.

## CLEANING AND STORAGE

We recommend that you clean the air purifier at least once every 3 months and before extended storage. Use only a dry cloth to wipe the external surfaces of the air purifier.

**DO NOT USE WATER, WAX, POLISH, OR ANY CHEMICAL SOLUTION.**

If your Air Purifier will not be used for more than 30 days, we recommend:

- Remove the HEPA Filters from the unit.
- Wrap the HEPA Filters in an air tight plastic bag.
- Remove the Household Gas & Odor Reducing Pre-Filter and place it in an air tight plastic bag.

## FREQUENTLY ASKED QUESTIONS

**My Air Purifier is starting to make noise and the air output is less. What's wrong?**

The filters may be dirty. High amounts of particles can block the pores in the filter and stop the air from moving through it. Replace the filters.

**How long should I run my Air Purifier?**

The unit will be most effective when doors and windows are closed and should be run when you are at home.

**Can I wash any of the filters in my Air Purifier?**

No. Washing either filter will ruin it.

## ACCESSORIES AND REPLACEMENT FILTERS

You may be able to purchase Honeywell replacement filters at the store where you purchased your air purifier or they can be ordered directly at [www.HoneywellPluggedIn.com](http://www.HoneywellPluggedIn.com) or call **1-800-477-0457**.

To ensure stated product performance, use only Genuine Honeywell Replacement Filters

- Certified HEPA Filter  model HRF-H1 (single pack) or HRF-H2 (2 pack)
- Household Gas & Odor Reducing Pre-Filter  model HRF-B1 (single pack) or HRF-B2 (2 pack)

## CONSUMER RELATIONS

We are here to help answer any questions you may have about this product.

Call us toll-free at: **1-800-477-0457**, or visit our website at: [www.HoneywellPluggedIn.com /contact-us](http://www.HoneywellPluggedIn.com/contact-us).

**Please be sure to specify the model number of the unit you are contacting us about.**

**NOTE: IF YOU EXPERIENCE A PROBLEM, PLEASE CONTACT CONSUMER RELATIONS FIRST OR SEE YOUR WARRANTY. DO NOT RETURN TO THE UNIT TO THE ORIGINAL PLACE OF PURCHASE. DO NOT ATTEMPT TO OPEN THE MOTOR HOUSING YOURSELF, DOING SO MAY VOID YOUR WARRANTY AND CAUSE DAMAGE TO THE AIR PURIFIER OR PERSONAL INJURY.**

## 5 YEAR LIMITED WARRANTY

**You should first read all instructions before attempting to use this product.**

- A.** This 5 year limited warranty applies to repair or replacement of product found to be defective in material or workmanship. This warranty does not apply to damage resulting from commercial, abusive, unreasonable use or supplemental damage. Defects that are the result of normal wear and tear will not be considered manufacturing defects under this warranty. **KAZ USA, INC. IS NOT LIABLE FOR INCIDENTAL OR CONSEQUENTIAL DAMAGES OF ANY NATURE. ANY IMPLIED WARRANTY OF MERCHANTABILITY OR FITNESS FOR A PARTICULAR PURPOSE ON THIS PRODUCT IS LIMITED IN DURATION TO THE DURATION OF THIS WARRANTY.** Some jurisdictions do not allow the exclusion or limitation of incidental or consequential damages or limitations on how long an implied warranty lasts, so the above limitations or exclusions may not apply to you. This warranty gives you specific legal rights, and you also may have other rights which vary from jurisdiction to jurisdiction. This warranty applies only to the original purchaser of this product from the original date of purchase.

- B.** At its option, Kaz USA, Inc. will repair or replace this product if it is found to be defective in material or workmanship.
- C.** This warranty does not cover damage resulting from any unauthorized attempts to repair or from any use not in accordance with the instruction manual.
- D.** This warranty DOES NOT cover the pre-filter or the HEPA filters, except for material or workmanship defects.

Please go to [www.HoneywellPluggedIn.com/warranty-registration](http://www.HoneywellPluggedIn.com/warranty-registration) to register your product and receive product information updates a new promotional offers.